

Clevertronics Clever-test

The Clevertronics Clever-test Lifelight (DLIFE-PRO-SMC) can be programmed to perform 90 minute discharge tests at 6-month intervals. A manual test is initiated by pressing the test switch 3 times within a 5s period (immediate discharge test). A 24 hour delayed test (to allow batteries to fully charge before a test) can be initiated by pressing the test switch and hold for 10 seconds (i.e., until LED Test Switch indicator flashes rapidly). Refer Clever-test Operation Guide for more information. Once the test has been completed, maintenance personnel then view the Status Indicator of each fitting to determine a pass or failure:

SOLID RED (not flashing)	NORMAL – The luminaire is in a normal state charging and awaiting next discharge test.
SLOW YELLOW FLASH (2s Yellow, 2s Off)	TESTING – The luminaire is currently performing a test.
VERY SLOW YELLOW & RED (4s Yellow, 1s Red)	RECENTLY PASSED – The luminaire has previously tested and passed. This indication remains for 5 days after the completion of the test and then changes to SOLID RED to indicate a normal state.
FAST YELLOW & RED FLASH (0.5s Yellow, 0.5s Red)	FAILED LAST TEST – The luminaire has previously tested and failed to remain illuminated for the required duration. This indication will remain until the required maintenance work has been completed and the luminaire passes a subsequent discharge test.

Zoneworks and DATA Monitored Options

Lifelights with part numbers ZLIFE-PRO-SMC, ZLIFE-PRO-SMC-DATA are fitted with Zoneworks communications modules (nodes). These fittings are monitored using either Powerline Carrier Technology that utilising the power cable to provide data communication or a dedicated data cable to/from data routers installed on a dedicated data trunk connected to a central Server (can also be connected via Ethernet/Internet/Fibre). Zoneworks software on the server is used to monitor, coordinate testing and collate test data from each Lifelight. Zoneworks Lifelights can be commissioned by a single push of the test switch, or scanning of the supplied barcode. The LED Test Switch indicator provides a multifunction indication of the status of the Lifelight during testing and normal operation:

State	LED Operation
Commissioned	LED on Solid (Red)
Un-commissioned	LED flashes at 0.5Hz (0.5s Red, 0.5s Yellow)
Emergency Light Test In Progress	LED flashes at 3s On (Yellow) & 0.5s Off

In the case of the DATA version a 2-way “figure 8” cable and terminal block facilitates the connection to the DATA network via a multi-drop bus (daisy chain connection). For further information of installation of a Zoneworks LW system, please refer to the Zoneworks Users Guide and Commissioning Guide (incl. DATA version)

DALI EM Option

Lifelights with part numbers ZLIFE-PRO-SMC-DALI are fitted with DALI modules (nodes) that facilitate connection and integration to 3rd Party Lighting Control Systems. Before installing the ZLIFE-PRO-SMC-DALI please confirm that the Lighting Control System has the capability to monitor DALI Emergency Luminaires. The ZLIFE-PRO-SMC-DALI will be addressed and configured into the control system by the Lighting Control System Commissioning Technicians and not Clevertronics.

State	LED Operation
Commissioned/ Un-commissioned	LED on Solid (Red)
Emergency Light Test in progress	LED flashes at 1s On (Yellow) & 1s Off
“IDENTIFY COMMAND”	Fitting goes into emergency mode for 10 seconds

A 2-way “figure 8” cable and terminal block facilitates the connection to the DALI network OR a 5/6way “structured wiring system” lead and plug facilitating the power and DALI connection. DALI connections are marked as Da Da.

TM

LIFELIGHT-PRO-SMC

Surface Mount Emergency Luminaire

Installation & Maintenance Instruction Leaflet



Victoria (Head Office & Manufacturing)

Website: www.clevertronics.com.au

Email: info@clevertronics.com.au

Phone: +61 3 9559 2700

Fax: +61 3 9559 2799

New South Wales

Phone: +61 2 8805 6400

Fax: +61 2 8805 6444

Queensland

Phone: +61 7 3442 9700

Fax: +61 7 3442 9777

South Australia/Northern Territory

Phone: +61 8 8301 8800

Fax: +61 8 8351 8286

Western Australia

Phone: +61 8 9248 3720

Fax: +61 8 9248 3725

New Zealand

Phone: +64 800 548 448

Designed in Australia to comply with the requirements
of AS2293.3: 2005, AS/NZS CISPR15: 2009 & IEC
60598-2-22: Edition 3.1B

Models:

PLIFE-PRO-SMC (plus black, –BLK): Manufactured in China

DLIFE-PRO-SMC, ZLIFE-PRO-SMC, ZLIFE-PRO-SMC-DATA, ZLIFE-PRO-SMC-DALI (plus black, –BLK): Manufactured in Australia

240V, 50Hz

Spare Parts:

1510170 Battery, NiCad 7.2V 1800mAh

1100898 UK, LifelightProHead Assy, Rnd, Large, Gen2 NO RING, LT

8002070 PCA: Lifelight Pro Driver.

Important:

It is illegal for anyone, except for a licensed electrician to install or maintain this product. Before installation, ensure that the electricity supply has been switched off and isolated. Installation must be carried out in accordance with the relevant Australian and International Standards.

Installation:

This Lifelight-PRO-SMC Surface mount non-maintained Emergency Luminaire can be installed on solid or T-BAR ceilings or used to replace an existing unit.

- Locate the installation position.
- Refer Images and Dimensions below for the Cut-out Hole and other dimensions.
- Pre-drill mounting holes
- Mount base plate and use suitable fixings to secure the base plate into the pilot holes
- Bring in supply cables via the rear entry hole or via the end of the base plate (surface mount conduit entry)
- Terminate the supply cables to the L, N & E terminals (in the case of the –DALI or –DATA fittings terminate the DALI or DATA cable to the terminals marked Da Da or DATA).
- Install the top cover, containing the control gear, ensuring to reconnect the control gear assembly to the connector from the supply terminal block
- Ensure the Battery is connected
- Screw the cover to the base plate and, in the case of side/conduit entry remove the knock-out at the end of the cover to go cover the conduit

Upgrading a PLIFE-PRO-SMC to Clever-test, Zoneworks (incl. DATA) or DALI EM

All premium Lifelight Pro Emergency Luminaires (PLIFE-PRO-SMC) can be upgraded to Clever-test, Zoneworks, Zoneworks DATA or DALI EM.

When upgrading the Lifelight to be part of a Clever-test, Zoneworks, Zoneworks DATA system or DALI EM, ensure the jumper (J2) is removed before inserting the relevant smart node board. Failure to remove jumper J2, in this specific instance, will result in abnormal test result indication.

Images and Dimensions:

Mounting Bracket

Luminaire Dimensions

1. 245mm (L) x 128mm (D)

Mounting Hole Dimensions

1. 70mm x 70mm

Weight

2. 1.92kg

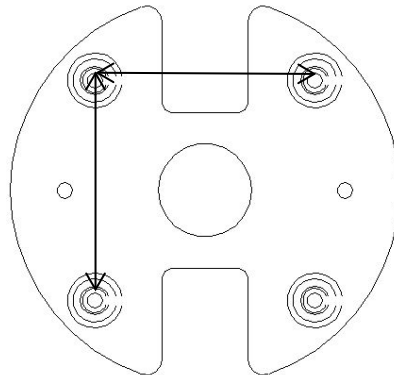

Initial Testing:

When the Lifelight PRO unit is connected to the un-switched active, it must be allowed to charge the battery for at least 24 hours. The emergency lamp only illuminates during a power failure. Conduct the following tests:

- During the first commissioning test the emergency lamp must illuminate for at least 2 hours after disconnection from the main supply. The results of all tests are required to be recorded in a service logbook, which is to be kept on-site at all times. If the unit fails to illuminate for the requisite time, remedial action must be taken to repair the situation and once completed, the unit must pass a subsequent test.
- Press and hold Test Button or switch Off Mains Supply, check that the emergency lamp is On.
- Release the Test Button or Switch on Mains Supply, check that the emergency lamp is Off (Non-maintained operation).

Below are a list of common problems and their possible causes:

Fault: The Red LED indicator is not illuminated.

Check: A.C. is connected and is turned on.
Battery is connected.
Test Switch for damage.

Fault: Lamp does not illuminate in emergency mode.

Check: A.C. is connected.
Lamp is correctly inserted.
Battery is connected

Fault: Lamp illuminates in emergency mode, but only stays on for a short period.

Check: Battery has been allowed to charge for at least 24 hours.
Battery for damage.

Rated Emergency Lumen Output in accordance with AS2293.1 (refer to spacing tables for installation positions):

Refer to the Technical Label for classification information.

Caution:

On many building sites, power circuits may be cut off in an uncontrolled and repetitive basis during construction. As a result, any Lifelight Units, on these circuits, will have their batteries discharged or “cycled”. The Li-ion battery in the Lifelight has been selected to give excellent long life performance in a controlled IEC 60598-2-22 testing environment. Excessive battery cycling will reduce through-life performance and may lead to premature battery failure. Battery warranty claims, as a result of such abuse, are specifically EXCLUDED from Clevertronics warranty terms.

Warranty:

For Product Warranty information and Terms and Conditions of Sales please refer to our website <http://clevertronics.com.au/terms-conditions-sale-australia-nz/>